

Airwheel F3

SMART DUAL-FILTER FRESH AIR MASK

USER MANUAL

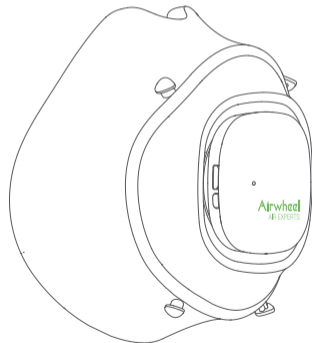

Diagram

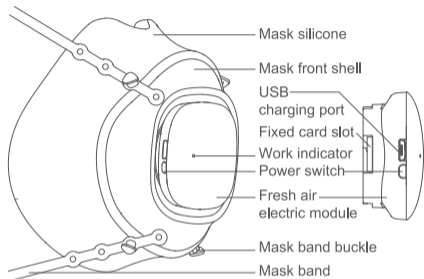

Packing list

Smart dual-filter fresh air mask	1 pcs	Tweezers	1 pcs
Mask band	2 pairs	Filter	1 pack (5 pieces)
Qualification certificate	1 unit	USB charging cable	1 piece
Instruction	1 unit		

Specifications

Product size (excluding mask band)	98X102X74mm	Shell material	PC Food Grade Silicone
Item weight	73g	Charging time	60min
Motor speed	8500RPM	Battery capacity	300mAh
Standard Voltage	3.7V	Cycle mode	Automatic fresh air
Maximum air volume	2.55CFM		

Instructions for use

1 Wearing method

Choose the proper hole position, fix the two ends of the mask band on the fixing buckle respectively, and put the mask band directly into the back of the head. There are two ways to wear the product: hanging ears and headset. Please choose according to your own conditions and habits.

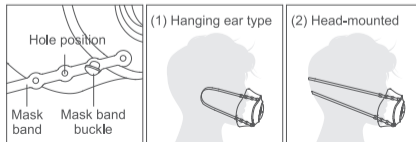

2 Start-up and Mode

The product has three modes (smart mode; first gear mode: comfortable mode means high wind speed; and second gear mode: energy saving mode means low wind speed). The factory default setting is comfortable mode. Press the power switch for a short time to turn on, the work indicator is always blue. After power on, short press the switch to energy saving mode, press again to turn off. Smart mode can only be adjusted via APP. For details, please refer to the smart APP description.

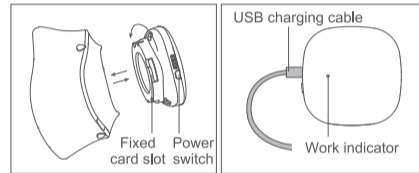

3 Power description

When the module is low power, the work indicator will flash blue at intervals. Plug the USB charging cable into the charging port of the fresh air electric module. The working indicator light continues to flash blue slowly, and it is full after 60 minutes of charging.

4 Fresh air module disassembly

Rotate the fresh air electric module by 360° counterclockwise to detach it outward; align the module fixing slot with the buckle on the front cover of the mask, and rotate it clockwise by 360° to lock the fresh air module.

Filter change

If the filter is used for a long time, it will cause the accumulation of dust and fine particles, which will affect the smoothness of breathing and reduce the filtering efficiency. Therefore, the filter needs to be replaced in a timely manner (depending on the use time and environment). If not used for a long time, it is recommended to remove the filter and keep it sealed.

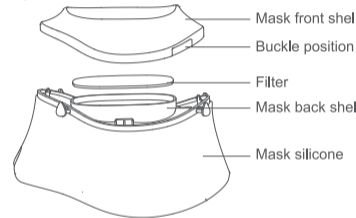

How to change the filter

Hold the clasp and pull it upwards. After opening the front shell, use tweezers to remove the old filter. After replacing the new filter, tighten the front and rear shells of the mask firmly to complete the replacement.

Automatic shut-down

When the mask is working, the system will automatically detect the state of the mask. If the movement state is not detected, the mask will automatically shut down after 5 minutes. You can turn off the automatic shutdown function through the APP.

Download APP



Scan QR code to download

*Applicable to Android 4.3 or higher, iOS 8.0 or higher.

APP Instructions

1. Turn on the F3 power, start the APP, and turn on Bluetooth at the same time
2. Follow the steps below.
3. For details, please refer to the official website or call for consultation.

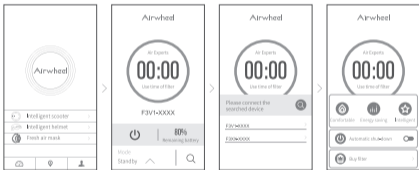

Click the fresh air mask in the App interface.

Click the main interface button

Select and connect the device.

Click ^ at the bottom to bring up the mode switching page, which can be freely selected according to personal needs.

Warning of security

Before you use the fresh air mask for the first time, please read this chapter thoroughly and thoroughly understand the precautions in order to use this product safely and comfortably, which is very important to you. In case of accident, please contact the manufacturer.

Please try to prevent fresh air electric module from being hit hard

If the product is dropped or hit, please check it immediately for damage. If you find any abnormal operation, please stop using it and contact customer service.

Avoid using the product in an excessively humid environment

This product is not suitable for use in environments such as rain and high temperature.

Warning of charging

1. This product only supports charging with a standard 5V power supply to avoid product damage due to improper charging.
2. Keep the product away from fire sources during use or storage, and avoid using the product in a high temperature (higher than 50°C) environment for a long time.
3. When charging, keep it in a safe place out of the reach of children.
4. Turn off the power when not in use.
5. If not used for a long time, it needs to be fully charged and shut down. It can't be more than 3 months since the last charge.



Warning

- Fresh air electric module is only suitable for use with this product. If you experience dizziness, dullness, etc. after use, you should stop using it immediately. It is forbidden to use in patients with heart disease, hypertension and respiratory diseases.
- When using this product, please do not disassemble the internal battery without permission. The company will not bear any responsibility if it poses a safety hazard.

Precautions

1. Please do the cleaning and maintenance of the product in time: clean it regularly and replace the filter in time;
2. This product is for personal use and is not suitable for sharing with others;
3. Due to the characteristics of the product, please do not disassemble the internal battery without permission, which will cause the machine to be defective, and it is not within the scope of maintenance;
4. When the fresh air module is running, do not put your fingers into the air cavity to avoid injury.
5. When the fresh air module is running, do not insert foreign objects into the air cavity to avoid damage to the fresh air module.
6. The product has a built-in rechargeable battery. Please discard it according to local regulations. Do not dispose of the battery at will.

The final interpretation right of all terms and conditions in this manual belongs to the company.

Product cleaning and maintenance

1. The appearance of the product can be cleaned with alcohol. (Except for the filter and fresh air electric module, this product can be boiled and disinfected.) The silicone part of the mask can be removed along the snap on the rear shell of the mask. After removal, it can be washed with water / sterilized by alcohol or sterilized with boiling water. (The boiling water cleaning time should be about 3-5 minutes.)
2. After removing the mask band, you can use the same cleaning method as mask silicone.

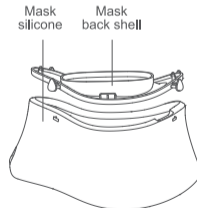

4. The air cavity can be wiped with a dust-free cloth, or a cotton swab dipped in alcohol to clean.
5. Do not immerse the fresh air module in water during cleaning.
6. Please change the filter in time according to the actual usage and smart APP reminder.



F3 warranty

From the date of purchase, users can enjoy the one-year warranty of the whole machine with the purchase ticket and valid warranty certificate. Consumables are not covered by the warranty (consumables include but are not limited to: mask silicone, filter, Mask band, etc.)

The following conditions do not enjoy warranty service

1. All faults and damage caused by human factors;
2. Damage caused by failure to use, maintain and maintain in accordance with the instructions for use;
3. Alter the invoice, have no warranty certificate, or exceed the warranty validity period;
4. The product model and manufacturing code of the warranty certificate do not match the product being repaired;
5. Damage of fresh air electric module due to water ingress;
6. Damage caused by force majeure such as fire, lightning, earthquake, etc.;
7. Failure caused by improper storage of users or accidents;
8. Normal use, wear, cracking and infection.

User Info

Name: _____ Phone: _____

E-mail: _____

Address: _____

Product information

Product Model: _____ Repair Date: _____

Maintenance Office Name: _____

Repair failure conditions: _____

Cause of issue: _____

SN: _____

Maintenance signature: _____

After-sales service information

If you want to get the address of the repair center or have other questions, please call the customer service hotline or log on to the website for inquiries.

Research: Airwheel Europe S.A.
Supervisor: Airwheel Holding Limited
Manufacture: Changzhou Airwheel Technology Co.,Ltd.

Address: 5th Floor, East Wing, Building No.10, High-Tech Park, Kewu Road, Xinbei District, Changzhou, Jiangsu, China
E-mail: after-sale@airwheel.net

The data is for reference only, please refer to the final product.



www.airwheel.net